

Brass Ball Valve with Red Locking Lever - NPT

- Up to 40 Bar
- Screwed NPT
- Blowout Proof Stem
- Maintenance Free
- Insulated Grip
- Long pattern
- Lever can have your logo printed.

DESCRIPTION

General purpose brass nickel plated ball valve, screwed NPT female standard pattern with RED PVC coated flat steel lockable lever. Full bore, with anti blow out stem and PTFE seats.

Good for general air and water duty.

Applications – compressed air lines, isolation of liquids.



Description

A brass nickel plated ball valve that's used in many general industrial applications throughout the UK and Europe. Full flow with anti blowout stem. Screwed NPT and fitted with a locking lever. RED Handle
Temperature range for fluids -20°C - +110°C
Pressure rating (see specifications)
The padlock is not included with the valve.



Beschreibung

Ein Kugelhahn aus Messing mit Nickelbeschichtung, der in vielen allgemeinen Industrieanwendungen in Großbritannien und Europa eingesetzt wird. Voller Durchfluss mit Anti-Blowout-Spindel. NPT geschraubt und mit einem Verriegelungshebel versehen. ROTER Griff
Temperaturbereich für Flüssigkeiten -20°C - + 110°C
Druckstufe (siehe technische Daten) Das Vorhängeschloss ist nicht im Lieferumfang des Ventils enthalten.



Descripción

Una válvula de bola de latón niquelado que se utiliza en muchas aplicaciones industriales generales en todo el Reino Unido y Europa. Flujo completo con vástago anti reventón. Atornillado NPT y equipado con una palanca de bloqueo. Mango rojo
Rango de temperatura para fluidos -20°C - + 110°C Presión nominal (ver especificaciones) El candado no está incluido con la válvula.



Description

Robinet à boisseau sphérique en laiton nickelé utilisé dans de nombreuses applications industrielles générales au Royaume-Uni et en Europe. Débit total avec tige anti-éruption. NPT vissé et équipé d'un levier de verrouillage. Poignée rouge
Plage de température pour les fluides -20°C à + 110°C Indice de pression (voir spécifications) Le cadenas n'est pas inclus avec la vanne.

Standard Pattern General Purpose
 Red coated PVC steel lever.
 NPT Thread
 LOGO can be embossed on the lever
 European Manufacturer

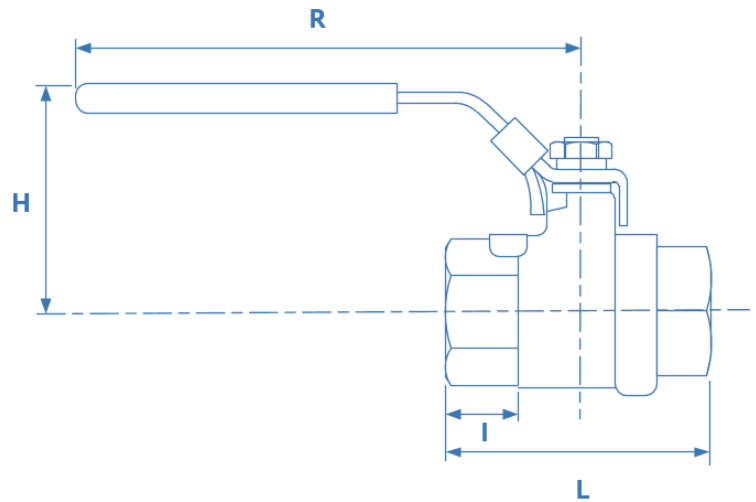

Dimensions shown are for guidance only

| Pressure / Temperature Ratings | |
|--------------------------------|------------------|
| Temperature | -20°C to 110°C |
| Working Pressure | PN40 ¼" - 1" |
| | PN25 1 1/4" - 2" |
| | PN16 2 1/2" - 4" |

| Dimensions | | | | | | |
|------------|-----|------|-----|-----|-----|------|
| Size | Ø | I | L | H | R | KG |
| 1/4" | 10 | 14 | 52 | 45 | 97 | 0.18 |
| 3/8" | 12 | 16.5 | 52 | 48 | 96 | 0.17 |
| 1/2" | 15 | 16 | 59 | 51 | 95 | 0.16 |
| 3/4" | 20 | 16 | 62 | 54 | 95 | 0.27 |
| 1" | 25 | 18 | 71 | 66 | 111 | 0.41 |
| 1 1/4" | 32 | 19 | 83 | 69 | 133 | 0.62 |
| 1 1/2" | 40 | 24 | 101 | 78 | 130 | 0.87 |
| 2" | 50 | 20 | 104 | 99 | 200 | 1.5 |
| 2 1/2" | 65 | 33 | 152 | 125 | 245 | 2.03 |
| 3" | 80 | 36 | 170 | 135 | 245 | 3.72 |
| 4" | 100 | 41 | 205 | 145 | 245 | 5.98 |

Typical Applications
 For use on Liquid and
 Pneumatic applications

| Material List | |
|---------------|--------------------------|
| Body | Nickel plated brass |
| Body End | Nickel plated brass |
| Seat | PTFE |
| Ball | Brass |
| Handle | Iron with insulated grip |
| O ring | NBR |
| Stem | Brass |