



SKU: CV5174

-  VOLT Wafer Spring Swing Check Valve in Carbon steel
-  VOLT Wafer Frühling Rückschlagklappe in Kohlenstoffstahl
-  VOLT Wafer primavera swing válvula de retención en acero al carbono
-  VOLT Wafer Spring swing Clapet en acier au carbone

Valves[™]
O N L I N E

- 2" - 8" Carbon Steel Spring Loaded Swing Check Valve PN25/16
- 2 - 8" Carbon Steel Spring Loaded Rückschlagklappe PN25 / 16
- 2" - 8" Acero al carbono primavera oscilación Cargado válvula de retención PN25 / 16
- 2" - 8" Carbon Steel Spring Loaded Balançoire Clapet PN25 / 16

CARBON STEEL

Wafer Swing Check Valve Spring Loaded

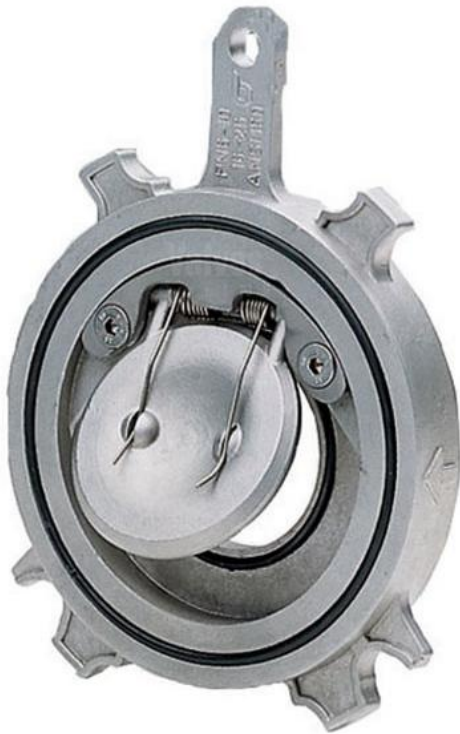

- **Wafer Pattern suits most flanges**
- **Space saving**
- **Low head loss**
- **Various seal options NBR (standard) ,Viton & PTFE**

Description:

A Carbon steel spring loaded swing check valve, offering an economical solution for various applications. The valve requires a low minimum pressure to open.

2" - 4" PN25 Rated

5" - 8" PN16 Rated



Description

Economical Carbon steel wafer type check valve with the option of various sealing options NBR (standard), Viton and PTFE making them suitable for a wide range of applications. Suitable for upward and horizontal flow.



Beschreibung

Wirtschaftlich Kohlenstoffstahl -Wafer Rückschlagventil mit der Möglichkeit, verschiedene Dichtungsoptionen NBR (Standard), Viton und PTFE so dass sie für eine Vielzahl von Anwendungen geeignet . Geeignet für Auf- und horizontale Strömung .



Descripción

Acero al carbono tipo oblea válvula de retención económica con la opción de las diversas opciones de sellado NBR (estándar) , Viton y PTFE que las hace adecuadas para una amplia gama de aplicaciones. Adecuado para flujo ascendente y horizontal .



Description

Économique acier au carbone type wafer clapet anti-retour avec l'option de diverses options d'étanchéité NBR (standard) , Viton et PTFE rendant aptes à une large gamme d'applications . Convient pour l'écoulement vers le haut et horizontale .

Temperatures

NBR Seat -20⁰ C to 100⁰ C

Viton Seat -20⁰ C to 150⁰ C

PTFE Seat -20⁰ C to 200⁰ C

-  VOLT Wafer Spring Swing Check Valve in Carbon steel
-  VOLT Wafer Frühling Rückschlagklappe in Kohlenstoffstahl
-  VOLT Wafer primavera swing válvula de retención en acero al carbono
-  VOLT Wafer Spring swing Clapet en acier au carbone

Carbon Steel Wafer Spring Swing Check

- Wafer Pattern suits most flanges
- Space saving
- Low head loss
- Various seal options NBR (standard) ,Viton & PTFE

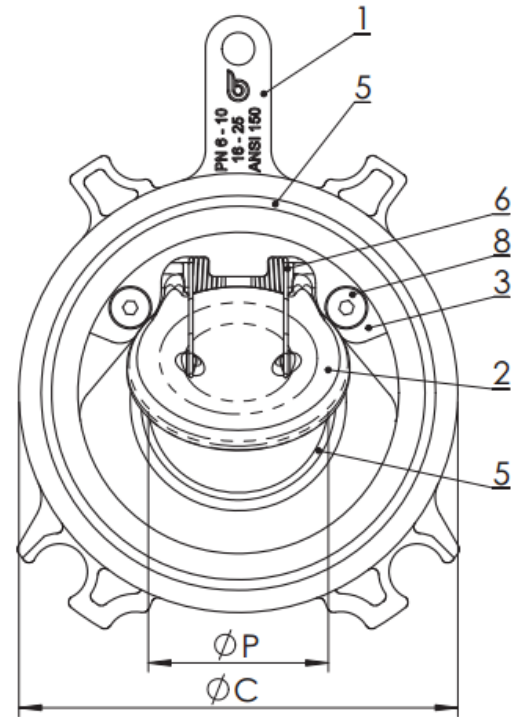
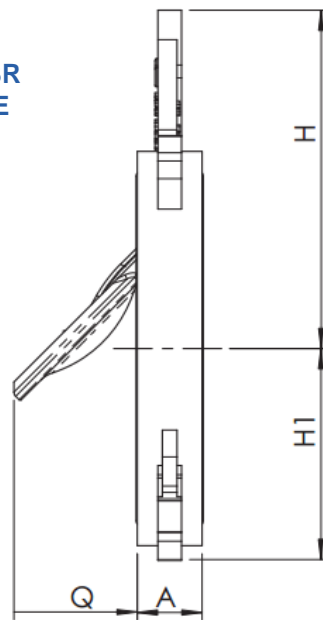

Dimensions



DN	P	A	C	H	H1	Q	Kg
50	33	18.5	99	98.5	53	30	0.82
65	43	18.5	118	107	63	44	1.25
80	53	22	134	115	73	56	1.83
100	75	23.5	154	131	92	70	2.42
125	96	29	184	138	119	80	3.1
150	118	34.5	208	137	149	96	5.3
200	164	36	264	169	167	125	8.5

Materials

1	Body	ASTM A216 gr. WCB
2	Disc	ASTM A216 gr. WCB
3	Plate	ASTM A351 gr. CF8M
5	O-ring	NBR, Viton, PTFE
6	Spring	AISI 302
8	Screw	Stainless Steel A2

Pressure/Temperature Ratings

Pressure	2" - 4" PN25
	5" - 8" PN16
Temperature	NBR (Standard) -20 C to 100 C
	Viton -20 C to 150 C
	PTFE -20 C to 200 C

-  VOLT Wafer Spring Swing Check Valve in Carbon steel
-  VOLT Wafer Frühling Rückschlagklappe in Kohlenstoffstahl
-  VOLT Wafer primavera swing válvula de retención en acero al carbono
-  VOLT Wafer Spring swing Clapet en acier au carbone

Carbon Steel Wafer Spring Swing Check

- Wafer Pattern suits most flanges
- Space saving
- Low head loss
- Various seal options NBR (standard) ,Viton & PTFE

Head loss Fluid: water (1m H₂O = 0,098bar)

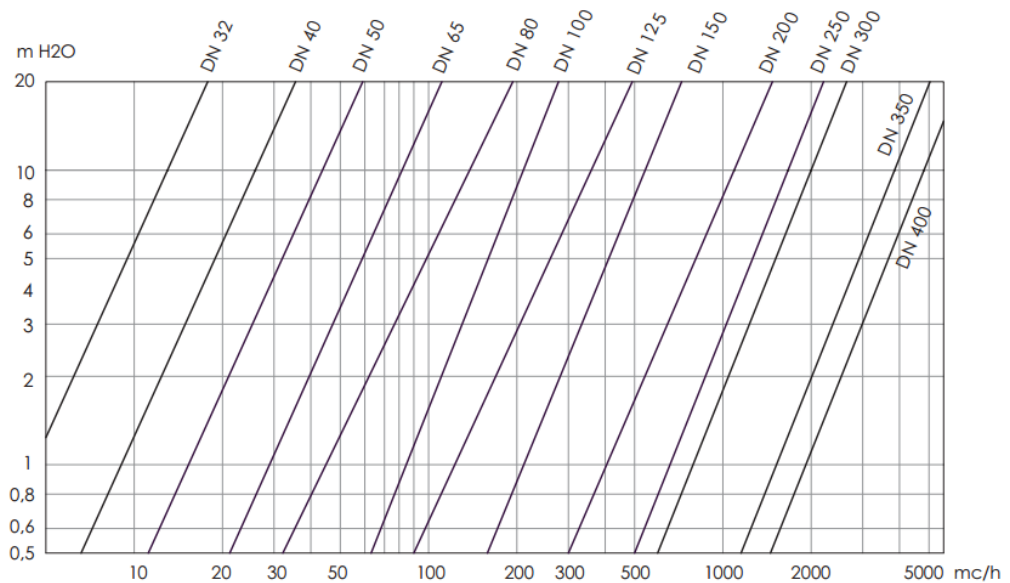

Kv							
DN	50	65	80	100	125	150	200
Kv	41	75	140	208	341	525	1093

Cracking Pressure							
DN	50	65	80	100	125	150	200
With Spring Flow Up	194	198	196	174	226	230	244
Without Spring Flow Up	126	130	120	106	126	130	136
With Spring Flow Horizontal	70	70	76	68	100	100	110