





SKU: GV5196

-  VOLT Cast Iron Flanged PN16 Globe Valve
-  VOLT Gusseisen mit Flansch PN16 Gangsventil
-  VOLT Reparto de válvula de globo con bridas PN16 Hierro
-  VOLT Fonte bride PN16 Globe Valve

Valves[™]
O N L I N E

- 1/2" - 12" Globe Valve in Cast Iron Flanged PN16
- 1/2" - 12" Durchgangsventil in Gusseisen mit Flansch PN16
- 1/2" - 12" Válvula de globo en hierro fundido con bridas PN16
- 1/2" - 12" Vanne en fonte à brides PN16

PN16 Cast Iron Globe Valve



- **PN16 Rated**
- **-10° C to 300° C**
- **Handwheel Operated**
- **Flanged BS4504**
- **Fluids: Air, Gas, Oil, & Water**

Description:

A Cast iron Flanged PN16 Globe Valve, Bolted Bonnet and Stainless Steel Trim.with Graphite Packing, Hand Wheel Operator. Rated PN16, Temperature -10°C to 300°C



Description

Bolted bonnet globe valve with a stainless steel valve disc is ideally suited for isolation duty, providing a leak-tight shut off with the capability of being used partially open to regulate flow.



Beschreibung

Deckelflansch Gangsventil mit einem Edelstahl Stahl Klappenscheibe ist ideal für die Isolierung Pflicht geeignet , eine leckdichteAbspernung mit der Fähigkeit, teilweise offen verwendet , um den Fluss zu regulieren..







Descripción

Atornillado válvula de globo con un capó de acero disco de la válvula de acero es ideal para el servicio de aislamiento , proporcionando un cierre estanco con la capacidad de siendo utilizado parcialmente abierta para regular el flujo .



Description

Boulonné chapeau de vanne globe avec un inox disque de vanne en acier est idéal pour les droits de l'isolement , fourniture d'une fermeture étanche aux fuites hors de la capacité de étant utilisé partiellement ouverte pour réguler le débit .

-  VOLT Cast Iron Flanged PN16 Globe Valve
-  VOLT Gusseisen mit Flansch PN16 Gangsventil
-  VOLT Reparto de válvula de globo con bridas PN16 Hierro
-  VOLT Fonte bride PN16 Globe Valve

Cast Iron Globe Valve - PN16

- **PN16 Rated**
- **-10° C to 300° C**
- **Handwheel Operated**
- **Flanged BS4504**
- **Fluids: Air, Gas, Oil, & Water**

Materials	
Body	Cast Iron EN-GJL-250
Bonnet	Cast Iron EN-GJL-250
Stem	X 20Cr13
Disc	X 20Cr13
Gasket	Graphite + NiCr
Handwheel	Ductile Iron EN-GJS-500-7

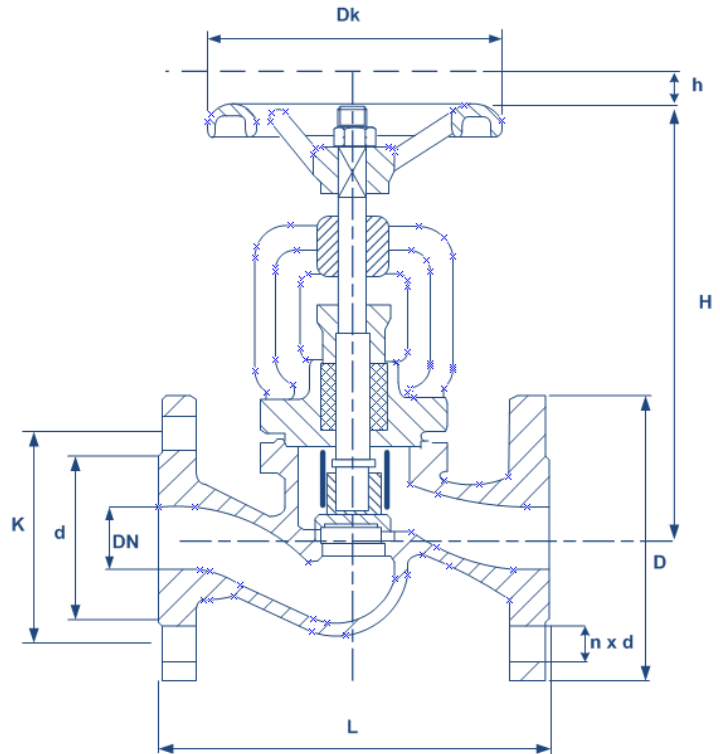
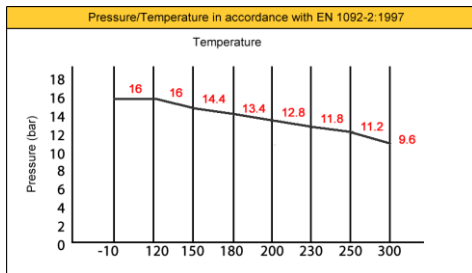

Dimensions											
Size	DN	PN16								Weight	Kv
		D	d	K	n x d	Dk	h	L	H		
mm										Kg	m³/h
1/2"	15	95	46	65	4 x 14	100	5	130	167	3.3	5.9
3/4"	20	105	56	75	4 x 14	100	5.5	150	167	3.9	7.4
1"	25	115	65	85	4 x 14	120	7	160	175	5	13
1 1/4"	32	140	76	100	4 x 19	120	14	180	186	6.6	18
1 1/2"	40	150	84	110	4 x 19	160	20	200	235	8.4	30
2"	50	165	99	125	4 x 19	160	25	230	248	12	41
2 1/2"	65	185	118	145	4 x 19	180	35	290	260	17.3	79
3"	80	200	132	160	8 x 19	200	41	310	291	22.7	115
4"	100	220	156	180	8 x 19	250	31	350	338	35.8	181
5"	125	250	184	210	8 x 19	250	48	400	384	52.8	225
6"	150	285	211	240	8 x 23	320	54	480	429	74.2	364
8"	200	340	266	295	12 x 23	360	77	600	529	126	690
10"	250	405	319	355	12 x 28	360	120	730	638	200	1010
12"	300	460	370	410	12 x 28	500	120	850	710	315	1460