

## ECONOMY SCREWED

## BSPT FLEXIBLE BELLOWS

## Key features:

- Reinforced EPDM body
- Malleable iron union ends
- Screwed BSP Taper BS21 (ISO 7/1)
- Sizes available: ½" to 3"
- Working temperature range: -20°C to +100°C
- Maximum working pressure: 16 bar



## DETAILS

This economy flexible bellows connector features a reinforced EPDM body and galvanised malleable iron union ends with screwed BSP Taper BS21 (ISO 7/1).

Available in sizes ½", ¾", 1" 1/4", 1½", 2", 2½", and 3".

Expansion joints are the perfect solution for pipe systems to absorb movements, vibrations or noise, resulting in the significantly prolonged service life of the pipe work and connected equipment.

The connector has a working temperature range of -20°C up to a maximum of +100°C and a maximum working pressure of 16 bar.

Available with NBR body on request.

## ECONOMY SCREWED

## BSPT FLEXIBLE BELLOWS

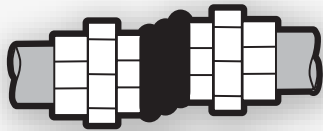
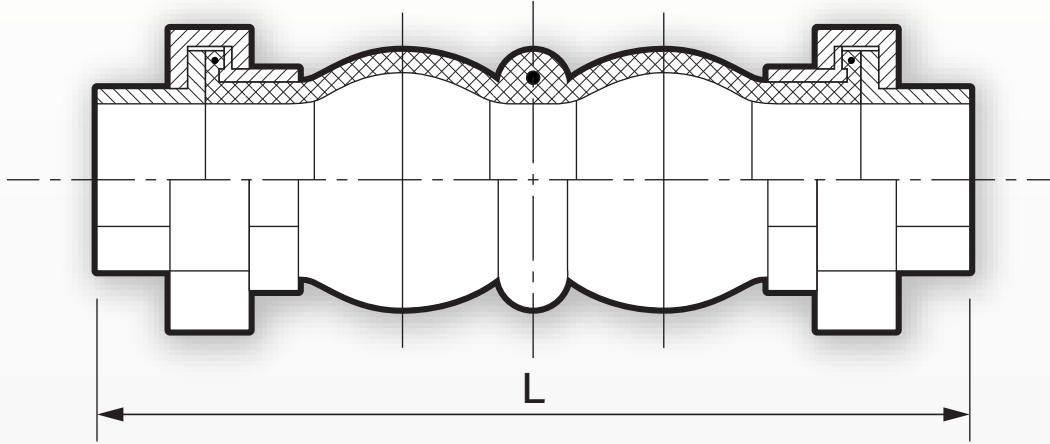

HD - Horizontal Displacement

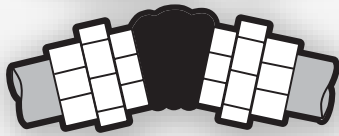

DA - Deflection Angular

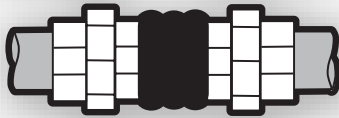

Ext - Extension

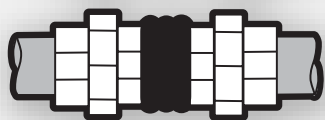

Comp - Compression

TABLE 1: DIMENSIONS IN MM

Size	L	HD	DA	Ext	Comp	Weight
½"	200	22	45°	5.6	22	0.70 kg
¾"	200	22	45°	5.6	22	0.90 kg
1"	200	22	45°	5.6	22	1.15 kg
1¼"	200	22	45°	5.6	22	1.40 kg
1½"	200	22	45°	5.6	22	1.65 kg
2"	200	22	45°	5.6	22	2.25 kg
2½"	245	22	45°	5.7	22	3.25 kg
3"	245	22	45°	5.8	22	4.20 kg

## ECONOMY SCREWED

## BSPT FLEXIBLE BELLOWS

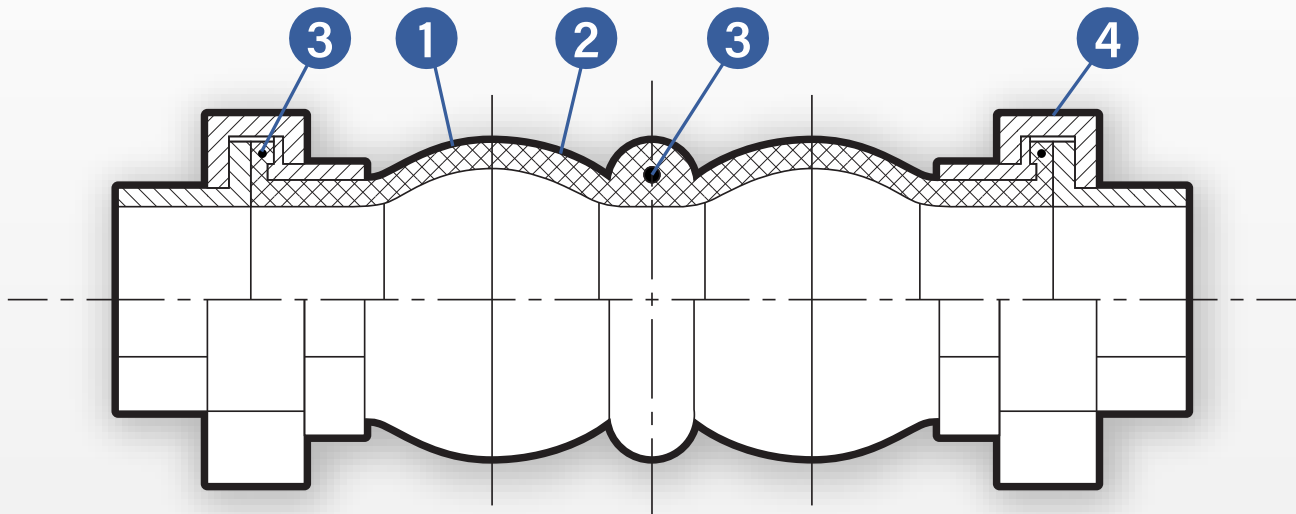
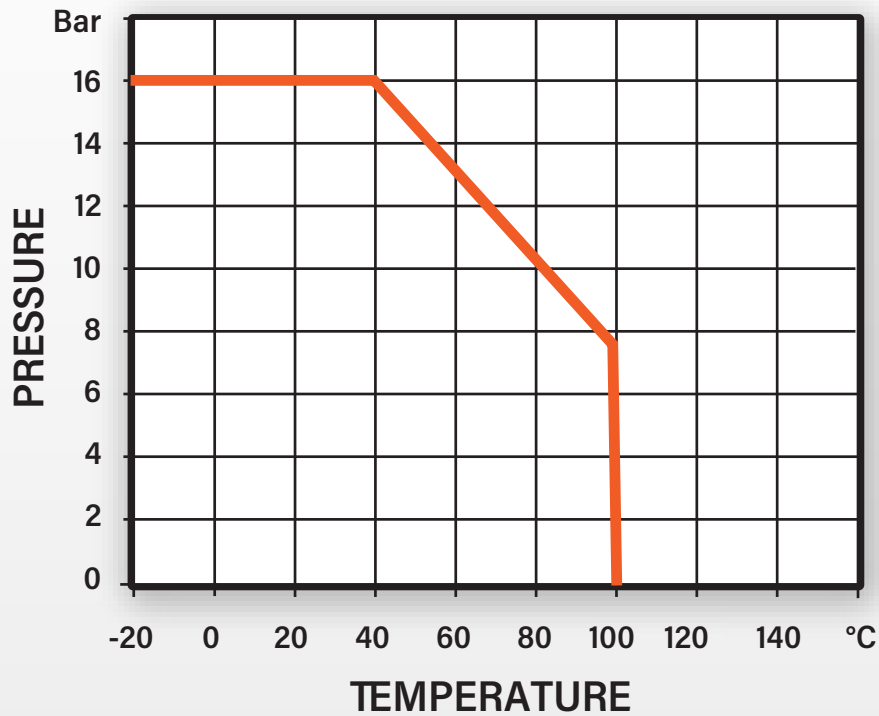

TABLE 2: PARTS AND MATERIALS

Item	Part Name	Material
1	Body	EPDM
2	Reinforcement	Nylon cord wire
3	Pressure ring	Steel wire
4	Union end	Malleable iron

CHART 1 : PRESSURE TEMPERATURE

TABLE 3: PART NUMBERS  
BSPT FLEXIBLE CONNECTOR

Size	SKU
½"	EJ9837-100101
¾"	EJ9837-100102
1"	EJ9837-100103
1¼"	EJ9837-100104
1½"	EJ9837-100105
2"	EJ9837-100106
2½"	EJ9837-100107
3"	EJ9837-100108