

ECONOMY METAL SEATED

FLANGED PN16 GATE VALVE

An economy gate valve offering the following key features:

- GG25 cast iron body
- Brass seat
- Hand wheel operated
- Non-rising stem
- Sizes available: 2" to 8"
- Flanged to suit PN16
- Face-to-face: DIN3202 F4



DETAILS

An economy, metal-seated, cast iron bodied (GG25) gate valve with a brass seat.

This valve is suitable to mount between PN16 flanges.

The face-to-face dimension meets DIN3202 F4.

Handwheel operated with a non-rising stem.

Available in sizes: 2" to 8"

Working temperature range of -10°C to +120°C at 16 bar and -10°C to +200°C at 12.8 bar.

Maximum working pressure: 16 bar. A cap top and tee key operator are available.

ECONOMY METAL SEATED

FLANGED PN16 GATE VALVE

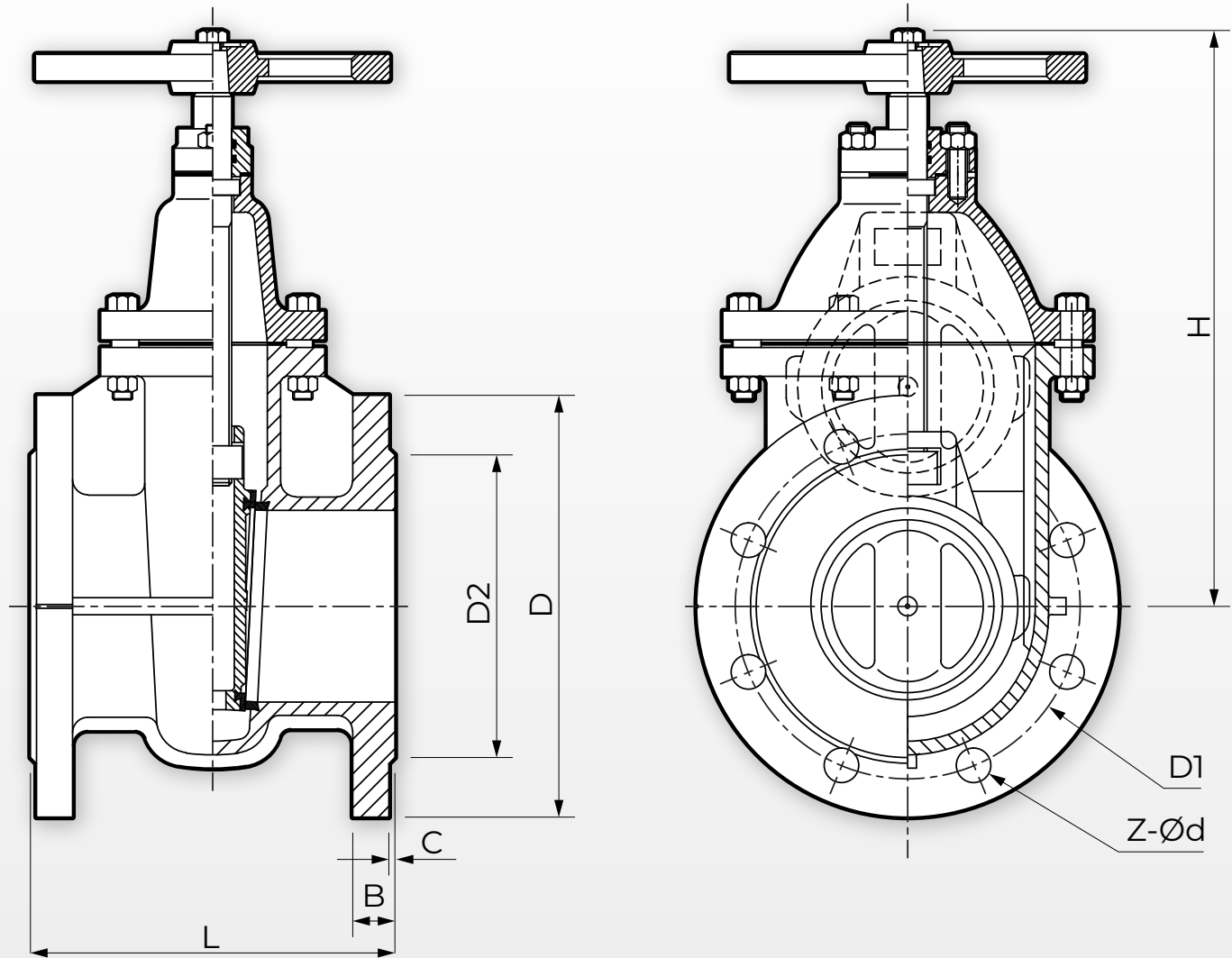

TABLE 1: DIMENSIONS IN MM

SIZE	L	D	D1	D2	B	C	Z-Ød	H
DN40	140	150	110	84	18	3	4-Ø19	179
DN50	150	165	125	99	20	3	4-Ø19	193
DN65	170	185	145	118	20	3	4-Ø19	236
DN80	180	200	160	132	22	3	8-Ø19	253
DN100	190	220	180	156	22	3	8-Ø19	300
DN125	200	250	210	184	24	3	8-Ø19	361
DN150	210	285	240	211	24	3	8-Ø23	405
DN200	230	340	295	266	26	3	12-Ø23	484
DN250	250	405	355	319	28	3	12-Ø28	575
DN300	270	460	410	370	28	3	12-Ø28	654

ECONOMY METAL SEATED

FLANGED PN16 GATE VALVE

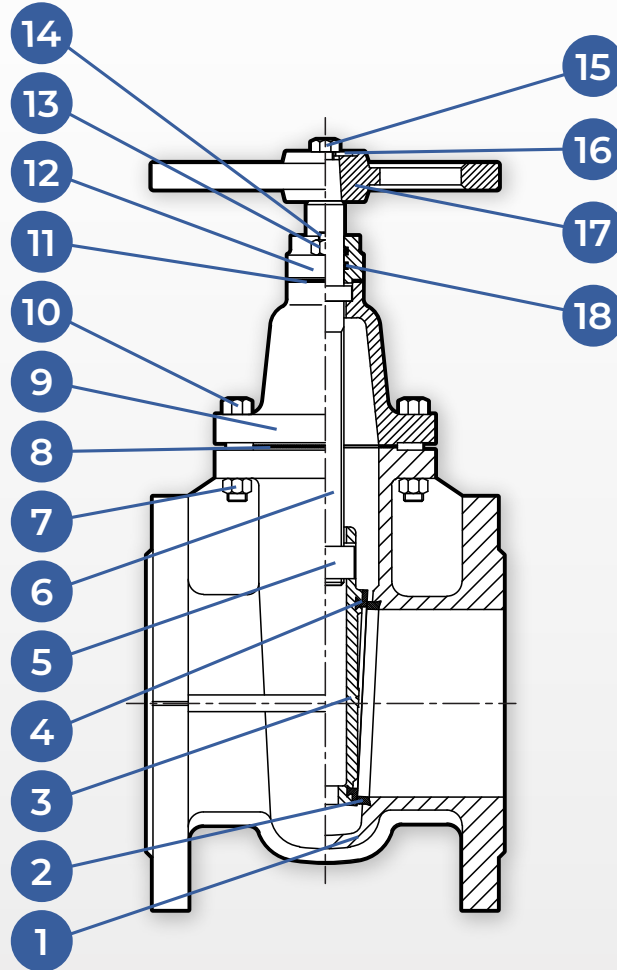

TABLE 2: MATERIALS

NO.	PART NAME	MATERIAL	MATERIAL STANDARD
1	Body	Cast iron	GG25
2	Body seat ring	Cast brass	ASTM B584
3	Wedge	Cast iron	GG25
4	Wedge ring	Cast brass	ASTM B584
5	Wedge bushing	Cast brass	ASTM B584
6	Stem	Stainless steel	ASTM 420 S42000
7	Nuts	Steel	ASTM A307 B
8	Body gasket	Graphite	-
9	Bonnet	Cast iron	GG25
10	Bolts	Steel	ASTM A307 B
11	Gasket	Rubber graphite	-
12	Packing gland	Cast iron	GG25
13	Nuts	Steel	ASTM A307 B
14	Bolts	Steel	ASTM A307 B
15	Bolts	Steel	ASTM A307 B
16	Washer	Steel	ASTM A307 B
17	Handwheel	Cast iron	GG25
18	O-ring	EPDM/NBR	-