

## BRASS NORMALLY OPEN 0-10 BAR

## STEAM SOLENOID VALVE

## Key features:

- Servo-assisted
- Normally open, 2-way operation
- Brass body
- PTFE seals and gaskets
- Screwed BSP connections
- Sizes available: 1/8", 1/4", and 3/8"
- Max. working pressure: 10 bar
- Pressure rating,  $\Delta P$ : 0 to 10 bar
- Operating voltages: 12V DC, 24V DC, 24V AC, 110V AC, and 230V AC
- Supplied with a cable plug



## DETAILS

A servo-assisted solenoid valve offering normally open, 2-way operation.

The valve features a brass body, stainless steel tube and internal parts, and PTFE seals and gaskets.

Available in sizes 1/8", 1/4", and 3/8" with BSP screwed end connections.

The valve should be mounted with the coil upright.

Designed for use with air, water, light oil and steam.

The valve has a maximum working pressure 10 bar, a pressure rating,  $\Delta P$  (differential pressure) of 0 to 10 bar.

Maximum media temperature of +180°C. Ambient temperature range of -20°C to +60°C.

Suitable operating voltages are 12V DC, 24V DC, 24V AC, 110V AC, and 230V AC, and supplied fitted with a cable plug.

## BRASS NORMALLY OPEN 0-10 BAR

## STEAM SOLENOID VALVE

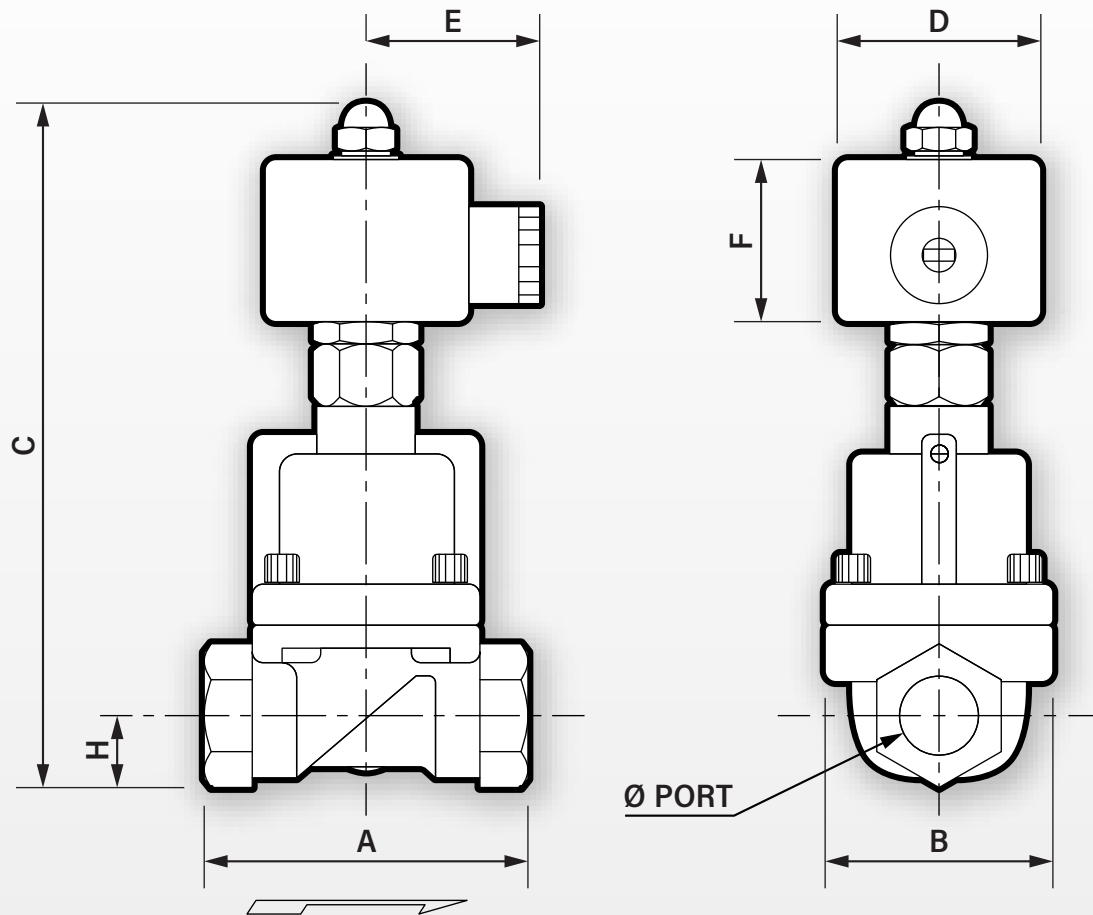

TABLE 1: DIMENSIONS IN MM

Size	A	B	C	D	E	F	H	Ø Port, BSP	Ø Orifice	Weight
1/8"	41	19	86	41	40	-	10.5	1/8"	3	0.35 kg
1/4"	41	19	86	41	40	-	10.5	1/4"	3	0.40 kg
3/8"	50	25	91	52	45	-	11.7	3/8"	4	0.50 kg

## BRASS NORMALLY OPEN 0-10 BAR

## STEAM SOLENOID VALVE

TABLE 2: FLOW (KV) IN L/MIN

Size	Flow (Kv)
1/8"	4.43
1/4"	4.43
3/8"	8.29

TABLE 3: ELECTRICAL DATA

Voltage (-10% + 10%) Continuous Duty 100%	Coil	Power Consumption		Insulation Class	Enclosure	Electrical Connections
		Inrush	Holding			
24V AC (50/60 Hz) 110V AC (50/60 Hz) 230V AC (50/60 Hz)	WPG2	18.7VA	15.3VA	H 180°C	IP65 with connector	3 spades DN 43650 DIN 40050 VDE 0110
12V DC 24V DC	WPG2	18 Watts	18 Watts	H 180°C	IP65 with connector	3 spades DN 43650 DIN 40050 VDE 0110

TABLE 4: PART NUMBERS

## SEAL MATERIAL: PTFE

Size	12V DC	24V DC	24V AC	110V AC	230V DC
1/8"	SV5637-100800	SV5637-100803	SV5637-100806	SV5637-100809	SV5637-100812
1/4"	SV5637-100801	SV5637-100804	SV5637-100807	SV5637-100810	SV5637-100813
3/8"	SV5637-100802	SV5637-100805	SV5637-100808	SV5637-100811	SV5637-100814