

BRASS NORMALLY OPEN 0.5-20 BAR

SOLENOID VALVE

Key features:

- Servo-assisted
- Normally open, 2-way operation
- Brass body
- PTFE seals and gaskets
- Screwed BSP connections
- Sizes available: 3/8" to 2"
- Max. working pressure: 20 bar (air/water)
- Pressure rating, ΔP : 0.5 to 20 bar (air/water)
- Max. working pressure: 12 bar (steam)
- Pressure rating, ΔP : 0.5 to 12 bar (steam)
- Operating voltages: 12V DC, 24V DC, 24V AC, 110V AC, and 230V AC
- Supplied with a cable plug



DETAILS

A servo-assisted solenoid valve offering normally open, 2-way operation.

The valve features a brass body, stainless steel tube and internal parts, and PTFE seals and gaskets.

Available in sizes 3/8" to 2" with BSP screwed end connections.

The valve should be mounted with the coil upright.

Designed for use with air, water, light oil and steam.

When used for air and water, the valve has a maximum working pressure of 20 bar and pressure rating, ΔP of 0.5 to 20 bar.

When used for steam, the valve has a maximum working pressure of 12 bar and pressure rating, ΔP of 0.5 to 12 bar.

Maximum media temperature of +180°C. Ambient temperature range of -20°C to +60°C.

Suitable operating voltages are 12V DC, 24V DC, 24V AC, 110V AC, and 230V AC, and supplied fitted with a cable plug.

BRASS NORMALLY OPEN 0.5-20 BAR

SOLENOID VALVE

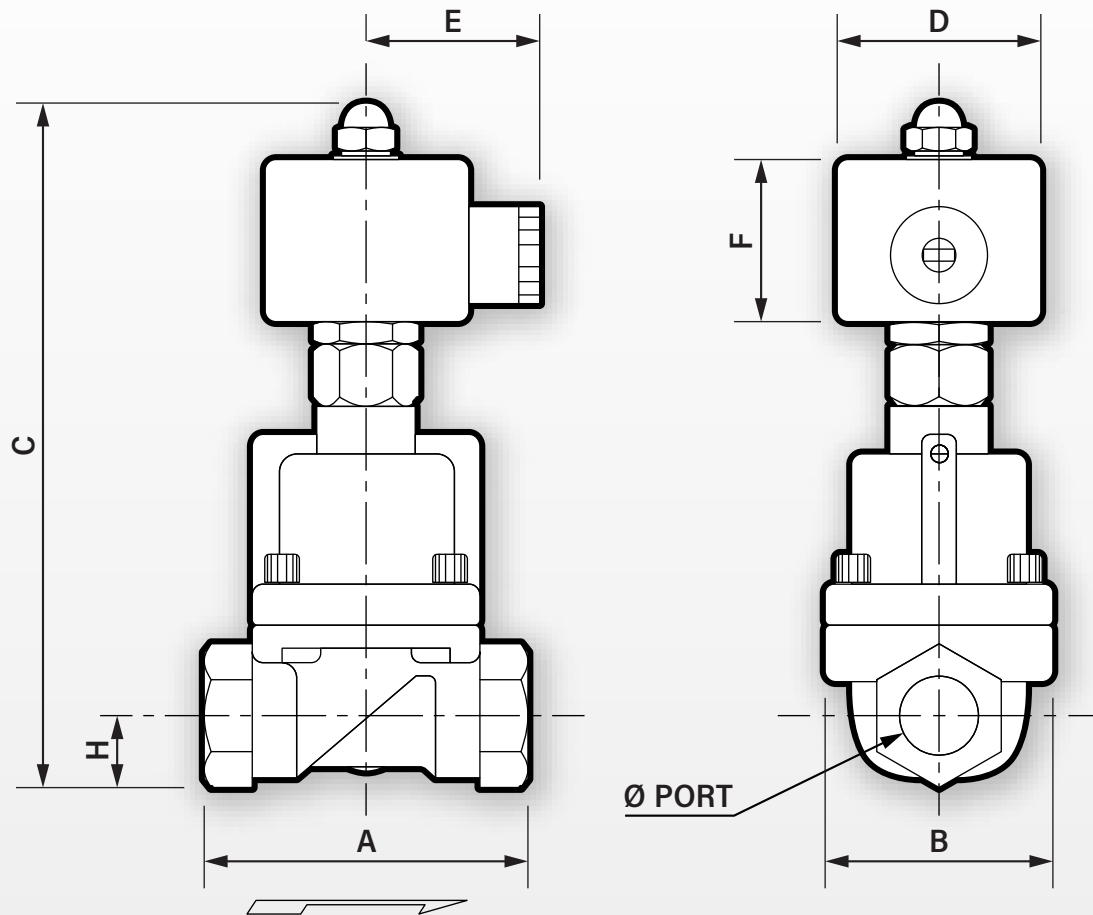

TABLE 1: DIMENSIONS IN MM

Size	A	B	C	D	E	F	H	Ø Port, BSP	Ø Orifice	Weight
3/8"	75	52	158	40	65	38	15.0	3/8"	15	1.65 kg
1/2"	75	52	158	40	65	38	15.0	1/2"	15	1.63 kg
3/4"	85	60	165	40	65	38	18.0	3/4"	20	2.13 kg
1"	100	70	172	40	65	38	23.0	1"	25	2.35 kg
1 1/4"	120	90	192	40	65	38	33.0	1 1/4"	35	3.85 kg
1 1/2"	120	90	192	40	65	38	33.0	1 1/2"	35	3.30 kg
2"	150	120	216	40	65	38	40.5	2"	50	7.35 kg

BRASS NORMALLY OPEN 0.5-20 BAR

SOLENOID VALVE

TABLE 2: FLOW (KV) IN L/MIN

Size	Flow (Kv)
3/8"	64.35
1/2"	64.35
3/4"	133.00
1"	188.76
1 1/4"	371.80
1 1/2"	371.80
2"	686.40

TABLE 3: ELECTRICAL DATA

Voltage (-10% + 10%) Continuous Duty 100%	Coil	Power Consumption		Insulation Class	Enclosure	Electrical Connections
		Inrush	Holding			
24V AC (50/60 Hz) 110V AC (50/60 Hz) 230V AC (50/60 Hz)	WPG2	18.7VA	15.3VA	H 180°C	IP65 with connector	3 spades DN 43650 DIN 40050 VDE 0110
12V DC 24V DC	WPG2	18 Watts	18 Watts	H 180°C	IP65 with connector	3 spades DN 43650 DIN 40050 VDE 0110

TABLE 4: PART NUMBERS

SEAL MATERIAL: PTFE

Size	12V DC	24V DC	24V AC	110V DC	230V DC
3/8"	SV5638-100815	SV5638-100822	SV5638-100829	SV5638-100836	SV5638-100843
1/2"	SV5638-100816	SV5638-100823	SV5638-100830	SV5638-100837	SV5638-100844
3/4"	SV5638-100817	SV5638-100824	SV5638-100831	SV5638-100838	SV5638-100845
1"	SV5638-100818	SV5638-100825	SV5638-100832	SV5638-100839	SV5638-100846
1 1/4"	SV5638-100819	SV5638-100826	SV5638-100833	SV5638-100840	SV5638-100847
1 1/2"	SV5638-100820	SV5638-100827	SV5638-100834	SV5638-100841	SV5638-100848
2"	SV5638-100821	SV5638-100828	SV5638-100835	SV5638-100842	SV5638-100849