

POWOGAZ CLASS B

WATER METER

Key features:

- Class B water meter
- Brass body
- Single jet
- Dry dial
- Threaded BSP connections
- Sizes available: ½" and ¾"
- Horizontal or vertical installation
- Maximum pressure: 16 bar
- Maximum working temperature: 30°C
- MID Approved
- WRAS Approved



DETAILS

A screwed BSP Class B water meter.

The meter features a brass body with a dry dial.

Available in sizes ½" and ¾" with threaded BSP connections.

The meter has a maximum working temperature of 30°C and maximum pressure of 16 bar.

The water meter is suitable for horizontal or vertical installation.

Available non-pulsed as standard with the option of a pulse transmitter available.

MID and WRAS Approved.



POWOGAZ CLASS B

WATER METER

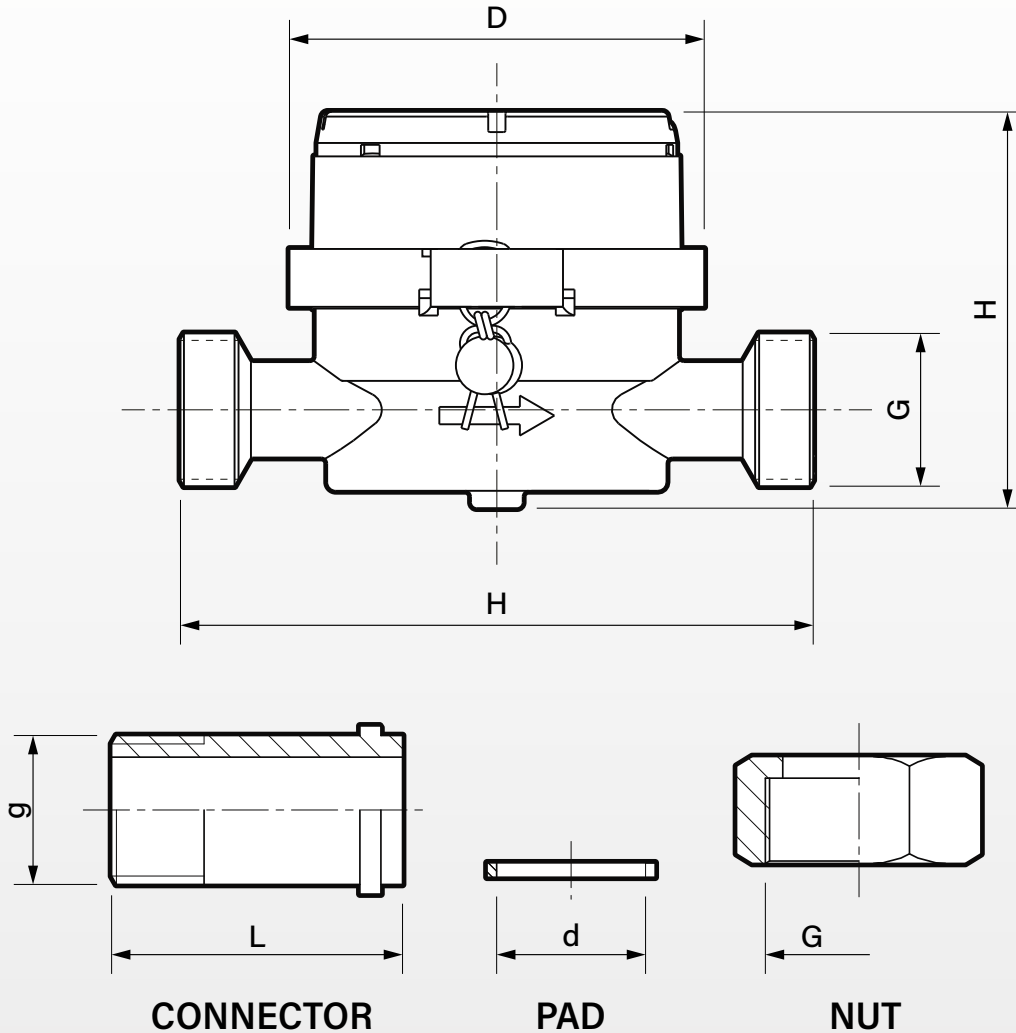

TABLE 1: DIMENSIONS IN MM

Size	G	H	L	D	g	d	L	Weight
1/2"	3/4"	68.5	110	72	1/2"	17	40	0.5 kg
3/4"	1"	68.5	130	72	3/4"	23	50	0.6 kg

TABLE 2: PART NUMBERS

Size	SKU	With Pulse Transmitter
1/2"	WM5612-100101	WM5612-100101-100103
3/4"	WM5612-100102	WM5612-100102-100103

POWOGAZ CLASS B

WATER METER

CHART 1: PRESSURE LOSS

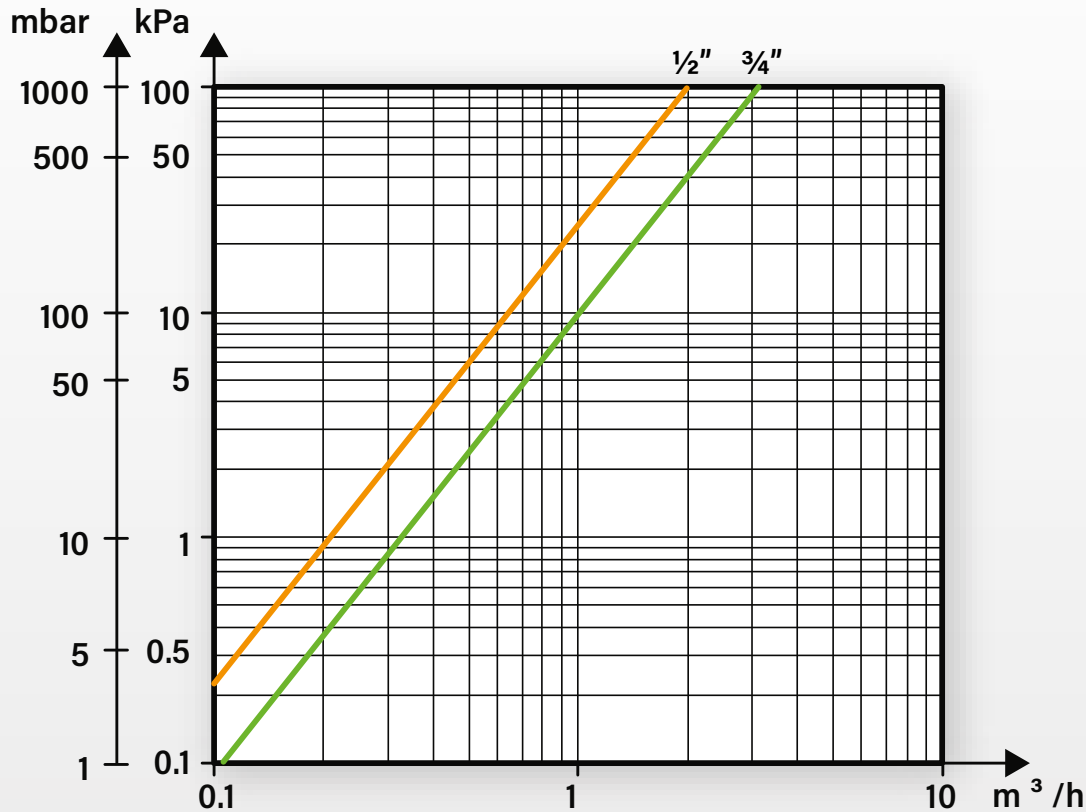

TABLE 3: TECHNICAL PARAMETERS

Parameter	Unit	1/2"	3/4"
Continuous Flow Rate (Q ₃)	m ³ /h	1.6	2.5
Maximum Flow Rate (Q ₄)	m ³ /h	2.0	3.125
Indirect Flow Rate - Horizontal (Q ₂)	dm ³ /h	25.6	40.0
Indirect Flow Rate - Vertical (Q ₂)	dm ³ /h	51.2	80.0
Minimum Flow Rate - Horizontal (Q ₁)	dm ³ /h	16.0	25.0
Minimum Flow Rate - Vertical (Q ₁)	dm ³ /h	32.0	50.0
Starting Flow	dm ³ /h	6.0	8.0
Ratio (Q ₂ / Q ₁)	-	1.6	1.6
Nominal Working Temperature	-	30°C	30°C
Resistance Classes to Flow Profiles	-	U0	U0
Indication Range	m ³	10 ⁵	10 ⁵
Indication Accuracy	m ³	0.00005	0.00005
Maximum Pressure (Pmax)	MPa	1.6	1.6
Maximum Pressure Loss for Q ₃ (Δp)	kPa	63.0	63.0
Permissible Error Range: Q ₂ ≤ Q ≤ Q ₄ (ε)	%	±2	±2
Permissible Error Range: Q ₁ ≤ Q ≤ Q ₂ (ε)	%	±5	±5